

LEVEL - 2

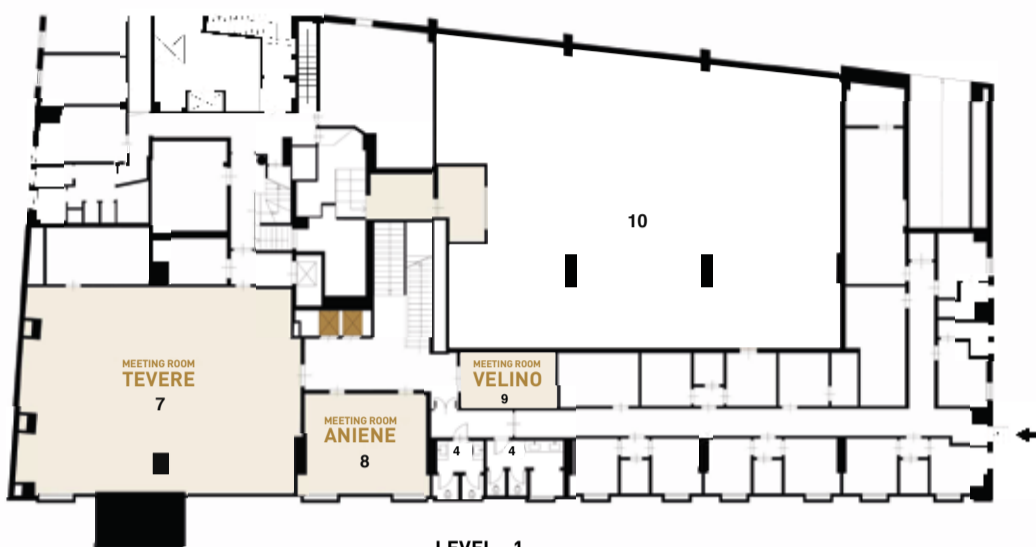

LEVEL - 1



INGRESSO MAIN ENTRANCE **GROUND FLOOR**  
VIA CAVOUR



**Legenda**

- 1 Main Entrance
  - 2 Hall
  - 3 Reception
  - 4 Toilette
  - 5 American Bar
  - 6 Restaurants
    - A Le Erbe
    - B Giardino
    - C Le Spighe
  - 7 Meeting Room Tevere
  - 8 Meeting Room Aniene
  - 9 Meeting Room Velino
  - 10 Meeting Room Cesarini
- Saletta A,B,C
- Elevator



GRAND HOTEL PALATINO ROMA

**PLAN YOUR EVENT**

MEETING ROOM | SETUP AND MAXIMUM CAPACITY OF SETUP



**MEETING ROOMS**

**DIMENSION  
HXWXL**

**FLOOR**

**AREA**

**NATURAL LIGHT**

**CABARET**

**COCKTAIL**

**BOARDROOM**

**U-SHAPE**

**CLASSROOM**

**THEATRE**

MEETING ROOMS	DIMENSION HXWXL	FLOOR	AREA	NATURAL LIGHT	CABARET	COCKTAIL	BOARDROOM	U-SHAPE	CLASSROOM	THEATRE
CESARINI	4x14,3x20,65	-2	295	☀	80	300	80	70	100	200
SALETTA A	3x5,1x6,15	-2	31		-	-	14	12	10	15
SALETTA B	3x5,1x6,75	-2	35		-	-	14	15	14	18
SALETTA C	3x5,1x6,75	-2	30		-	-	14	15	14	18
TEVERE	3x11x14	-1	153	☀	40	100	40	35	50	90
ANIENE	2,5x6,5x5,4	-1	38	☀	-	-	18	15	18	20
VELINO	2,8x2x4,4	-1	13	☀	-	-	6	-	-	8
BUSINESS ROOM 117	3x3,8x5,55	1	21,09	☀	-	-	10	8	10	15
RISTORANTE LE ERBE	4x7x13	Ground	139	☀	104	120	-	-	90	-
SALA GIARDINO	4x5x5	Ground	56	☀	40	45	-	-	40	-
RISTORANTE LE SPIGHE	4x5x10	Ground	84	☀	58	75	-	24	48	-

